



HANDY SHAMPOOER

Directions for use on upholstery & carpets.

(Do not use on velvet or crushed velvet fabric.)

- 1) Always vacuum upholstery or carpet before shampooing.
- 2) Unscrew head & fill applicator handle as per dilution markings; 1 part shampoo to 10 parts tepid/warm water. **DO NOT USE HOT WATER.**
- 3) Screw head on securely, do not over tighten and gently shake to mix the solution.
- 4) Hold brush flat against upholstery/carpet. Squeeze bottle gently to release solution needed. With pressure centred on the head, work foam into fabric with circular strokes, gradually covering entire soiled area.
NEVER OVER SATURATE FABRIC.
- 5) Allow fabric to dry completely, then vacuum thoroughly to remove dirt-holding residue.
- 6) Rinse unit & store with head lightly attached.

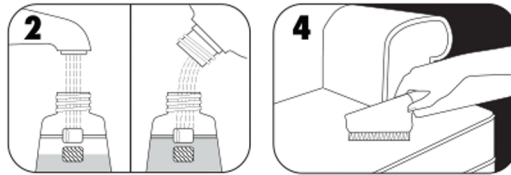

Ewbank LLC, 6801 Northpark Boulevard
Suite D, Charlotte, NC 28216, USA

Ewbank reserves the right to modify this product without prior notice. Images used are for illustration purpose only.



EB0591